

ICELAND SKATE SHOP

PROPOSED
ELECTRICAL 11/4/12

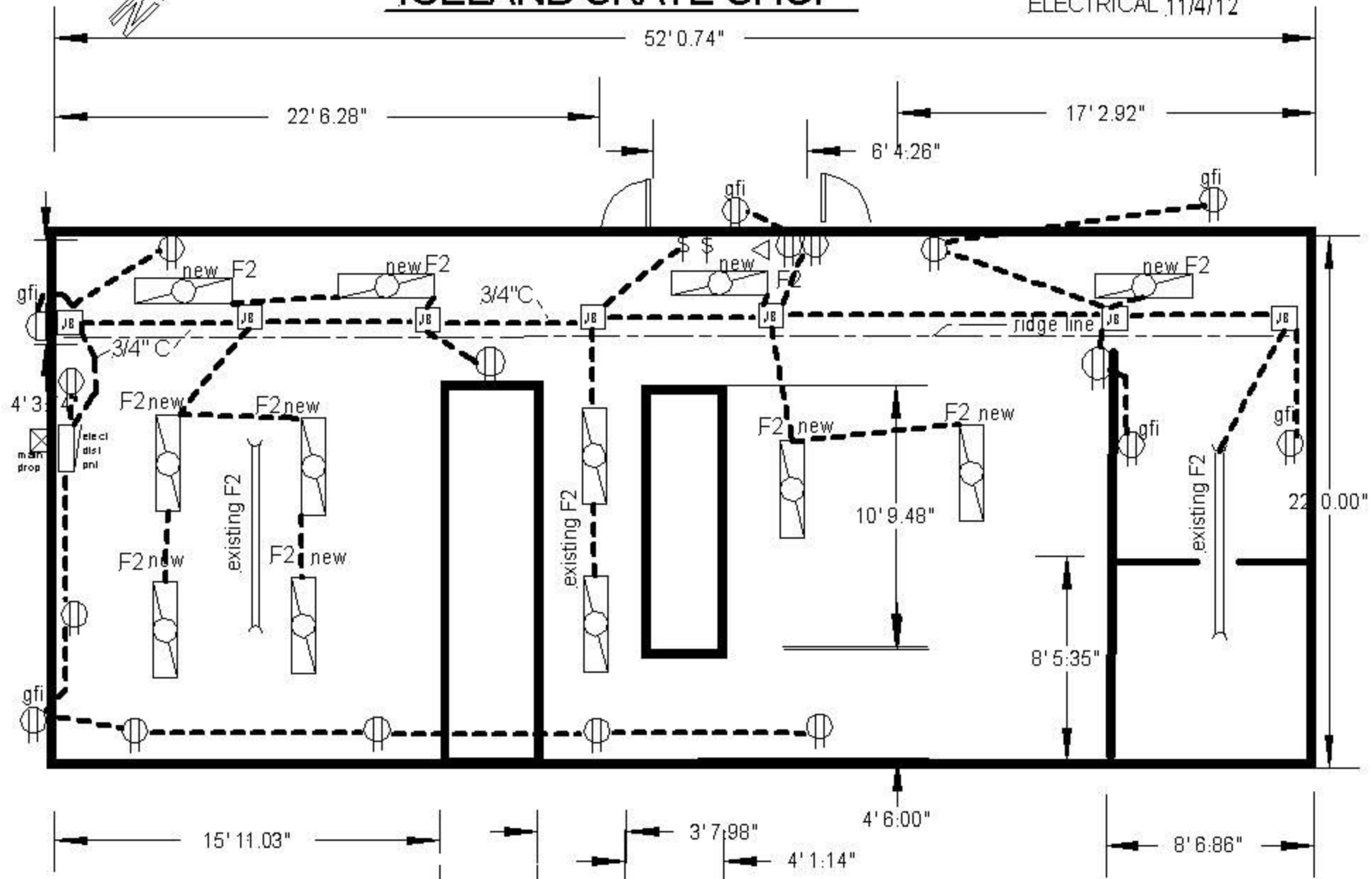

NOTES:

- all dimensions + or - 2 in
- F2 is a two bulb T8 4ft florescent lamp**
- JB** 6X6 junction box
- feeds from JB to F2 lights are 3/8 armored flex
- 3/4" EMT from JB to JB at ridge line, feeds to recepticals is EMT or 1/2" armor flex.